

West Building



Suite 950 - Beacon Ready

- 4,123 RSF
- Available Now
- [Beacon Ready Marketing Flyer](#)

 [VIRTUAL TOUR](#)

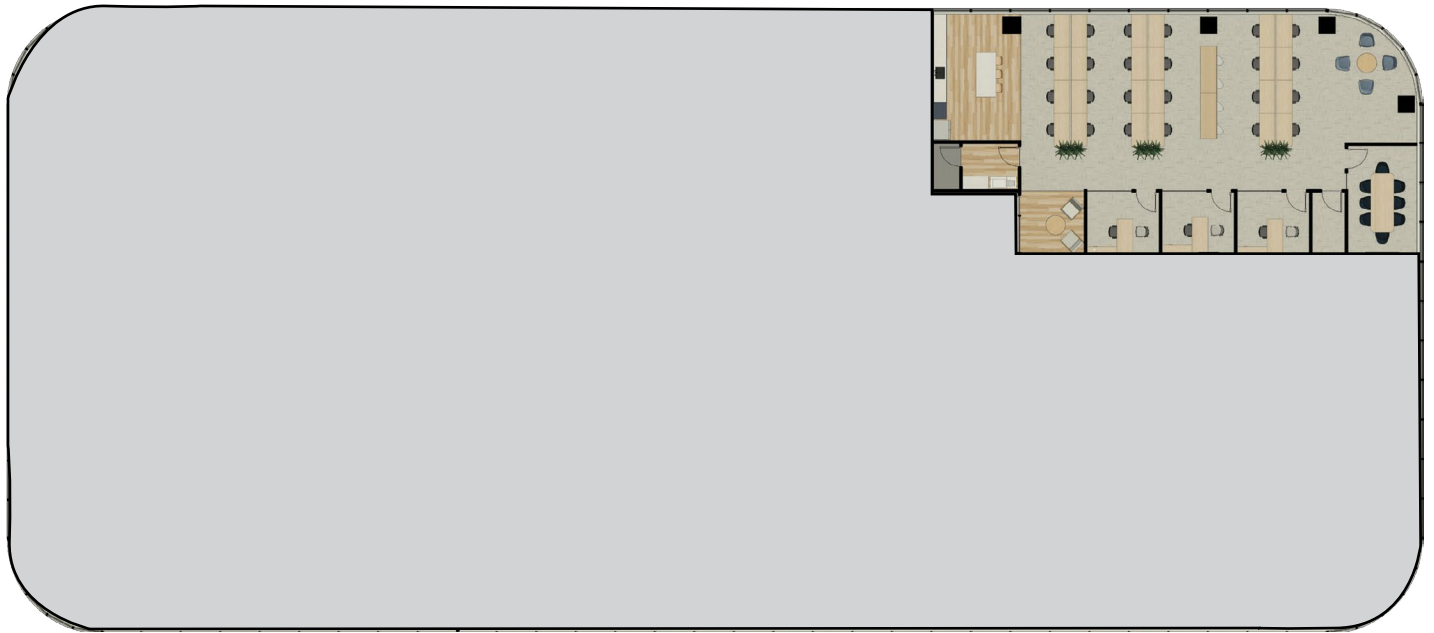

 [BACK TO AVAILABLE SPACE](#)

1100 Olive Way / 1730 Minor Avenue Seattle WA 98101
metparkseattle.com

BEACON

BRODERICK
GROUP

Larry Almeleh | 206.910.0859
almeleh@broderickgroup.com

Lauren Hallgrimson | 206.948.4440
hallgrimson@broderickgroup.com