



BELLEVUE PLACE BUILDING
10500 NE 8th Street
Bellevue, WA

BELLEVUE PLACE BUILDING

14th Floor • **Suite 1400** • 6,811 RSF



CLICK TO TAKE A
VIRTUAL TOUR

SPACE FEATURES

- Available Now
- Private offices
- Open area
- Open area for workstations
- Double glass door entry
- Direct elevator lobby exposure
- East facing with Bellevue CBD skyline views
- Configurable entry to fit an incoming tenant's needs

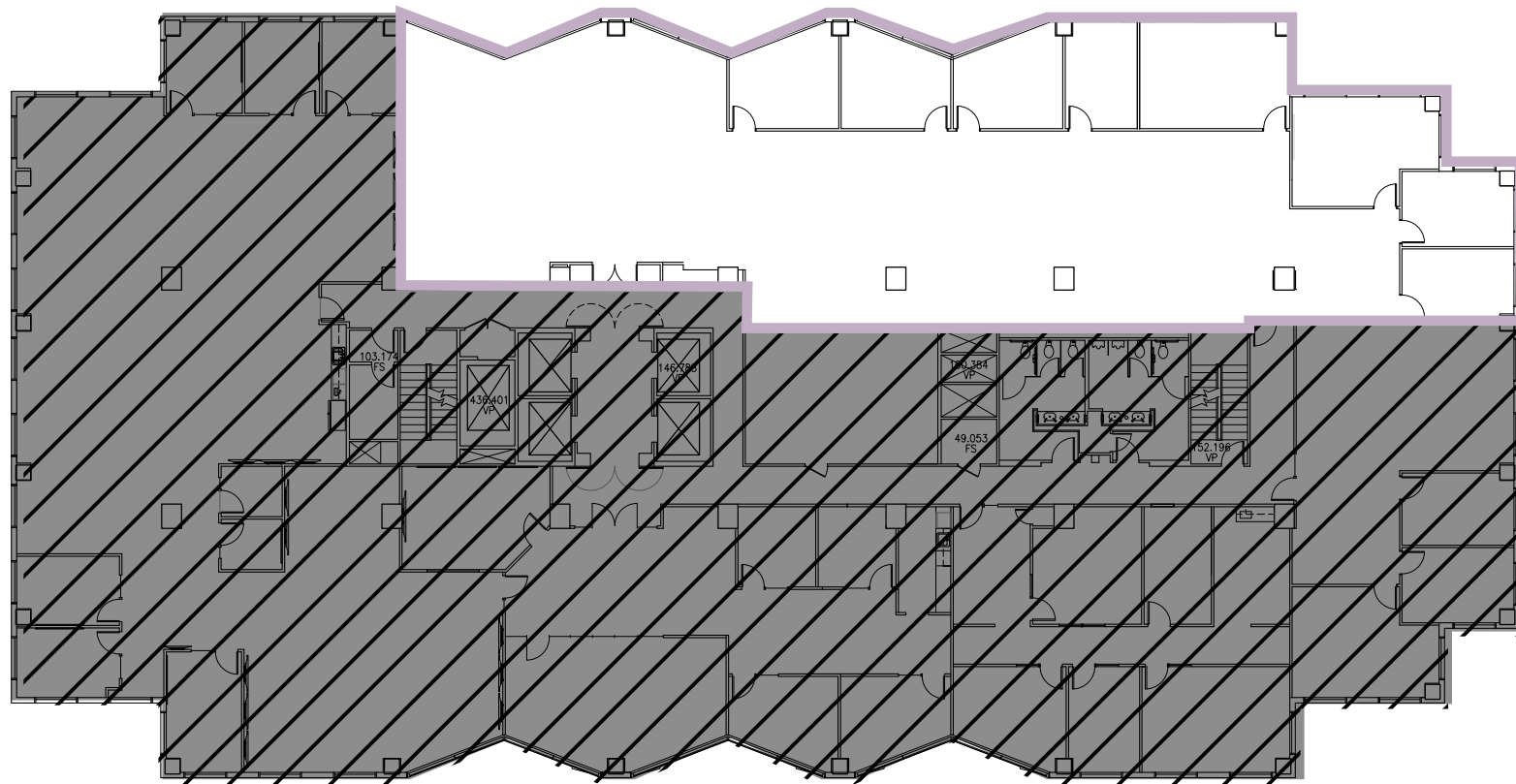

BRODERICK
• GROUP •

For more information or to schedule a tour, please
contact:

PAUL SWEENEY
425.646.5225

sweeney@broderickgroup.com

JIM KINERK
425.646.5221
kinerk@broderickgroup.com

CLAYTON HOLM
425.274.4287
holm@broderickgroup.com

The information contained herein has been given to us by the owner or sources which we deem reliable. We have no reason to doubt its accuracy, but we do not guarantee it. Prospective tenants should carefully verify all information contained herein.



BACK TO AVAILABLE SPACE



NORTH



BELLEVUE PLACE BUILDING
10500 NE 8th Street
Bellevue, WA

BELLEVUE PLACE BUILDING

14th Floor • Suite 1400 SAMPLE TEST FIT • 6,811 RSF



CLICK TO TAKE A
VIRTUAL TOUR

SPACE FEATURES

- Available Now
- 33 Workstations
- 7 office / small meeting rooms
- 1 large conference room
- 1 medium conference room
- Open concept break area
- Touchdown area with room for phone booths



BRODERICK
• GROUP •

For more information or to schedule a tour, please
contact:

PAUL SWEENEY
425.646.5225
sweeney@broderickgroup.com

JIM KINERK
425.646.5221
kinerk@broderickgroup.com

CLAYTON HOLM
425.274.4287
holm@broderickgroup.com

The information contained herein has been given to us by the owner or sources which we deem reliable. We have no reason to doubt its accuracy, but we do not guarantee it. Prospective tenants should carefully verify all information contained herein.



BACK TO AVAILABLE SPACE



NORTH