



# PARK EAST







Northwest Building<sup>LLC</sup>



# PARK EAST



## BUILDING HIGHLIGHTS



Suite E120 is a fantastic single story R&D or creative office space. Exposed ceilings, conditioned space with polished concrete & grade level loading.



Generous parking:  
3 stalls/ 1,000 SF



Close proximity  
to retail



Estimated Clear Height to  
Deck: Approx. 13'



Excellent access to  
highways & light rail



*The information contained herein has been given to us by the owner or sources that we deem reliable. We have no reason to doubt its accuracy, but we do not guarantee it. Prospective tenants should carefully verify all information contained herein.*

## AVAILABILITY

SUITE	RSF	AVAILABILITY
A115	4,740 RSF	9/1/2025
B102	3,107 RSF	8/1/2025
E120	24,236 RSF	8/1/2025



# PARK EAST

18047 - 18211 NE 68TH STREET | REDMOND, WA



Northwest Building LLC

## SUITE A115

4,740 RSF

1,754 SF Office & 2,986 SF Warehouse

Available 9/1/2025

2 Grade level loading doors

Visibility to NE 68th St

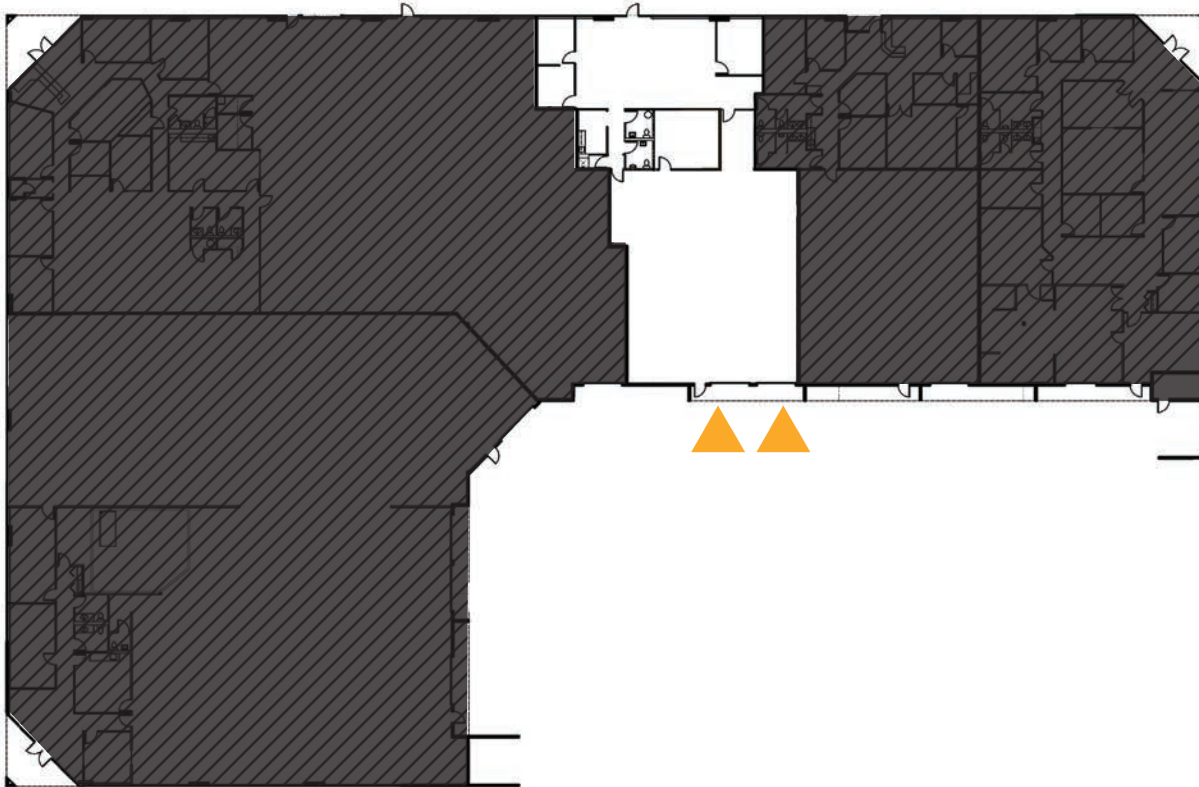

▲ GRADE-LEVEL  
LOADING



TYLER SLONE | 425.274.4281 | [slone@broderickgroup.com](mailto:slone@broderickgroup.com)

ERIC MEUSSNER | 425.274.4282 | [meussner@broderickgroup.com](mailto:meussner@broderickgroup.com)



# PARK EAST

18047 - 18211 NE 68TH STREET | REDMOND, WA



Northwest Building LLC

## SUITE B102

3,107 RSF

Available 8/1/2025

Ownership will consider short term deals

Currently built out as a Hot Yoga Studio with mens and womens shower and lockers

Established yoga studios, pilates, cross-fit, physical therapy and gym users to be considered

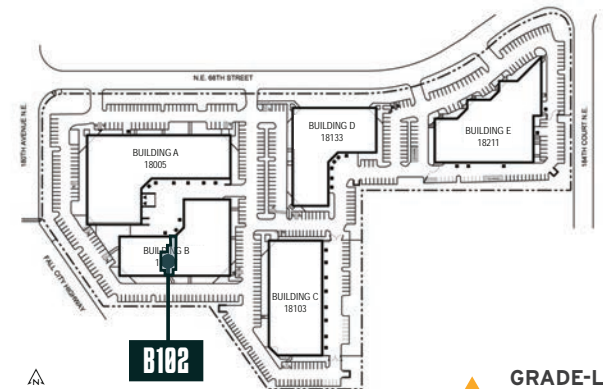





# PARK EAST

18047 - 18211 NE 68TH STREET | REDMOND, WA



Northwest Building LLC



CLICK TO TAKE A  
VIRTUAL TOUR

## SUITE E120

24,236 RSF

Available 8/1/2025

Fantastic single story R&D or creative office space

Exposed ceilings, fully conditioned  
with polished concrete entries

Approx. 1,708 SF warehouse with grade level  
loading (ability to expand warehouse and loading)

Estimated Clear Height to Deck: Approx. 13'

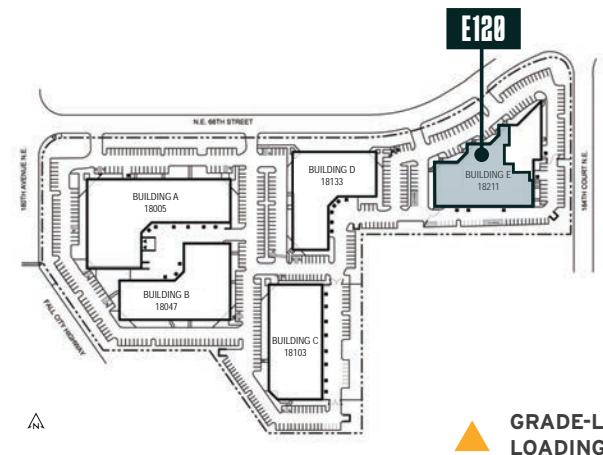
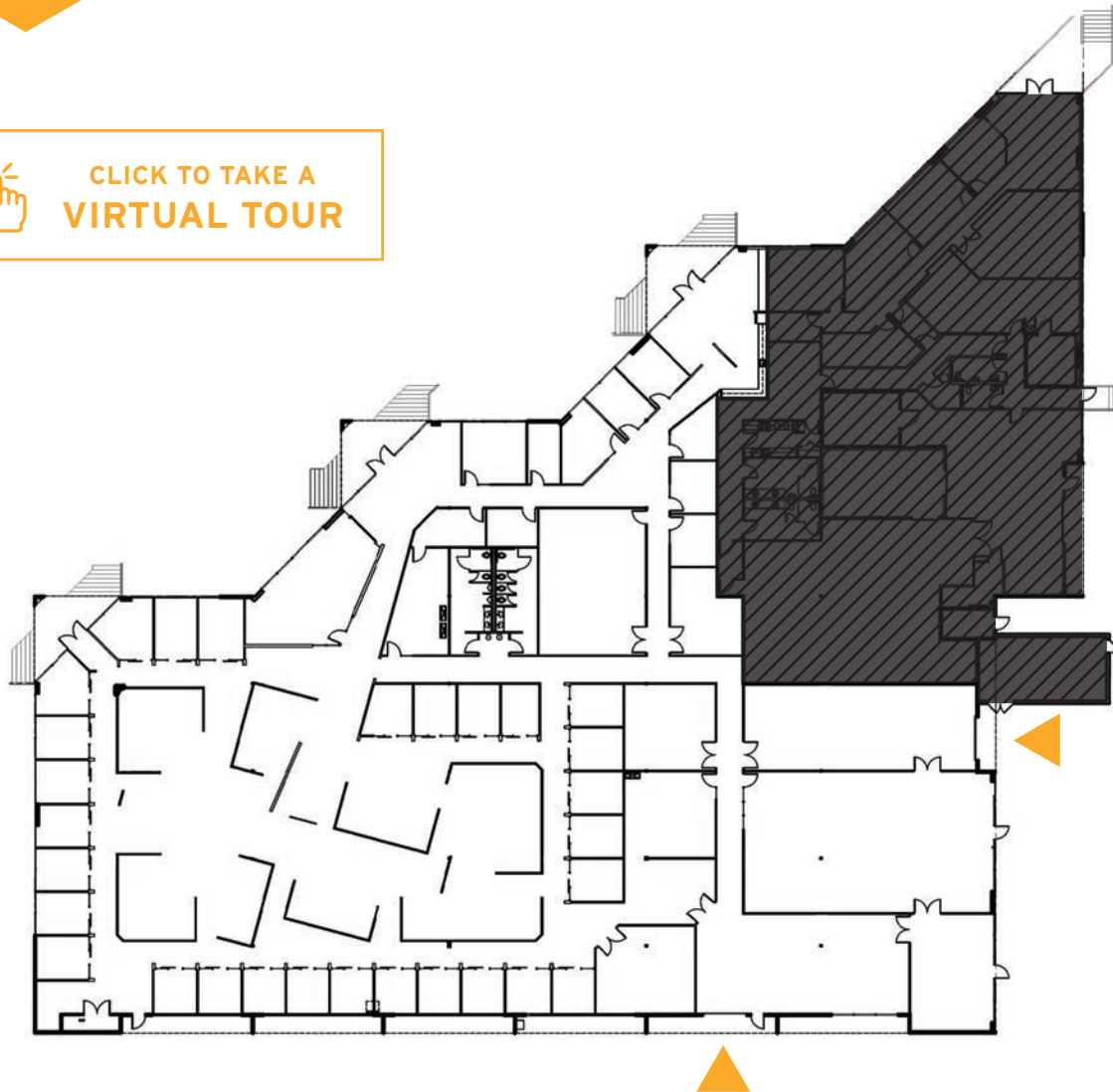

**BRODERICK**  
• GROUP •

TYLER SLONE | 425.274.4281 | slone@broderickgroup.com

ERIC MEUSSNER | 425.274.4282 | meussner@broderickgroup.com



# PARK EAST



Northwest Building LLC

18047 - 18211 NE 68TH STREET | REDMOND, WA

## BUILDING E - INTERIOR PHOTOS

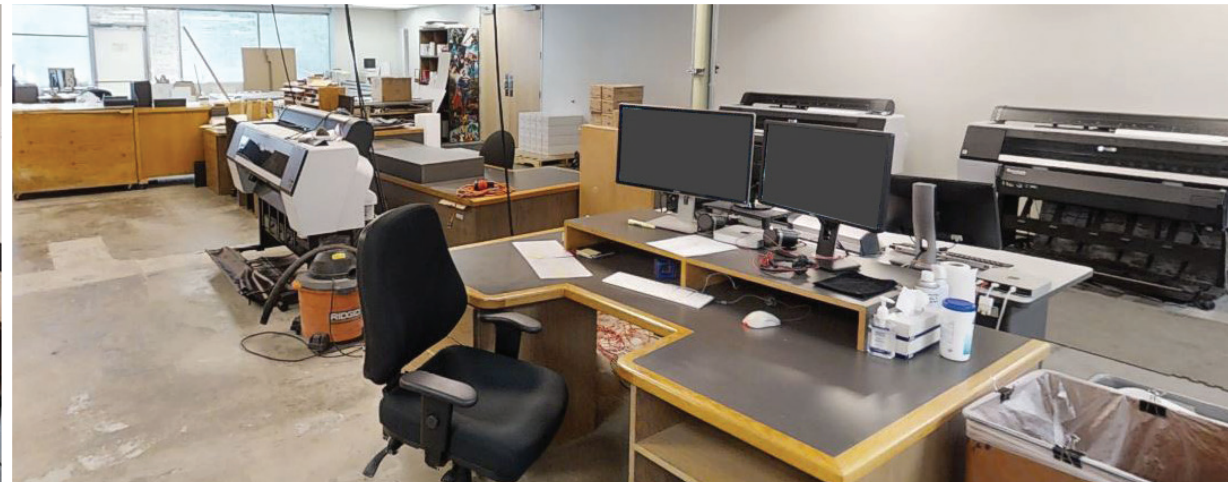
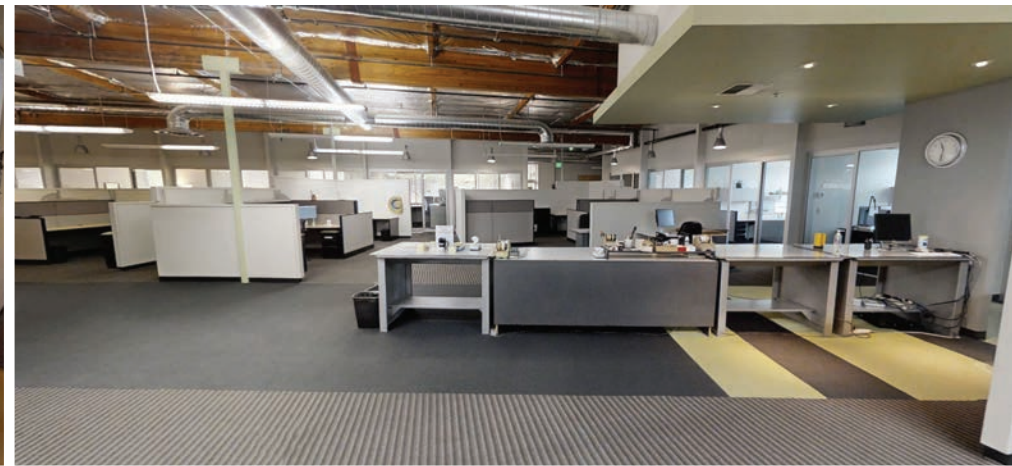

**BRODERICK**  
• GROUP •

TYLER SLONE | 425.274.4281 | [slone@broderickgroup.com](mailto:slone@broderickgroup.com)

ERIC MEUSSNER | 425.274.4282 | [meussner@broderickgroup.com](mailto:meussner@broderickgroup.com)





# AMENITIES

## LOCAL FOOD & DINING

- 1 Pomegranate Bistro
- 2 Jimmy John's
- 3 Chipotle
- 4 Subway
- 5 Postdoc Brewing
- 6 Asiana Bistro
- 7 Panera Bread
- 8 Agave Concina
- 9 Baskin Robbins
- 10 Fatburger
- 11 Mac & Jack's Brewery

## REDMOND TOWN CENTER

- |                             |                            |
|-----------------------------|----------------------------|
| 24 Hour Fitness             | Lunchbox Lab               |
| Bath & Body Works           | Orangetheory Fitness       |
| Big 5 Sporting Goods        | Petco                      |
| BJ's Restaurant & Brewhouse | Baskin Robbins             |
| Cold Stone Creamery         | Red Robin                  |
| Cost Plus World Market      | ShareTea                   |
| Fuji Steakhouse             | Starbucks                  |
| GAP                         | Thai Ginger                |
| IPIC Theaters               | The Original Pancake House |
| Just Poke                   | Zumies                     |

## COFFEE

- 12 Peet's Coffee & Tea
- 13 Starbucks
- 14 Blazin Bagels
- 15 Mercurys Coffee Co.

## LIFESTYLE

- 16 Sammamish Cleaners
- 17 Rite-Aid
- 18 Bank of America
- 19 Home Depot
- 20 Fred Meyer
- 21 Discount Tire
- 22 Target
- 23 Kohl's
- 24 ZenRock Fitness
- 25 Redmond Kindercare