



# SYMETRA<sup>®</sup>

CENTER

777 108<sup>th</sup> Avenue NE  
Bellevue, WA 98004

## 21<sup>TH</sup> FLOOR

**FULL FLOOR OPPORTUNITY FOR 19,085 RSF**

Suite 2100 • 9,233 RSF

Available 10/1/2026

- Financial services space with modern finishes and extensive views

Suite 2150 • 9,852 RSF

Available with 30 Days' Notice

- Fully furnished plug and play recently improved suite with direct elevator access
- West, North and East views

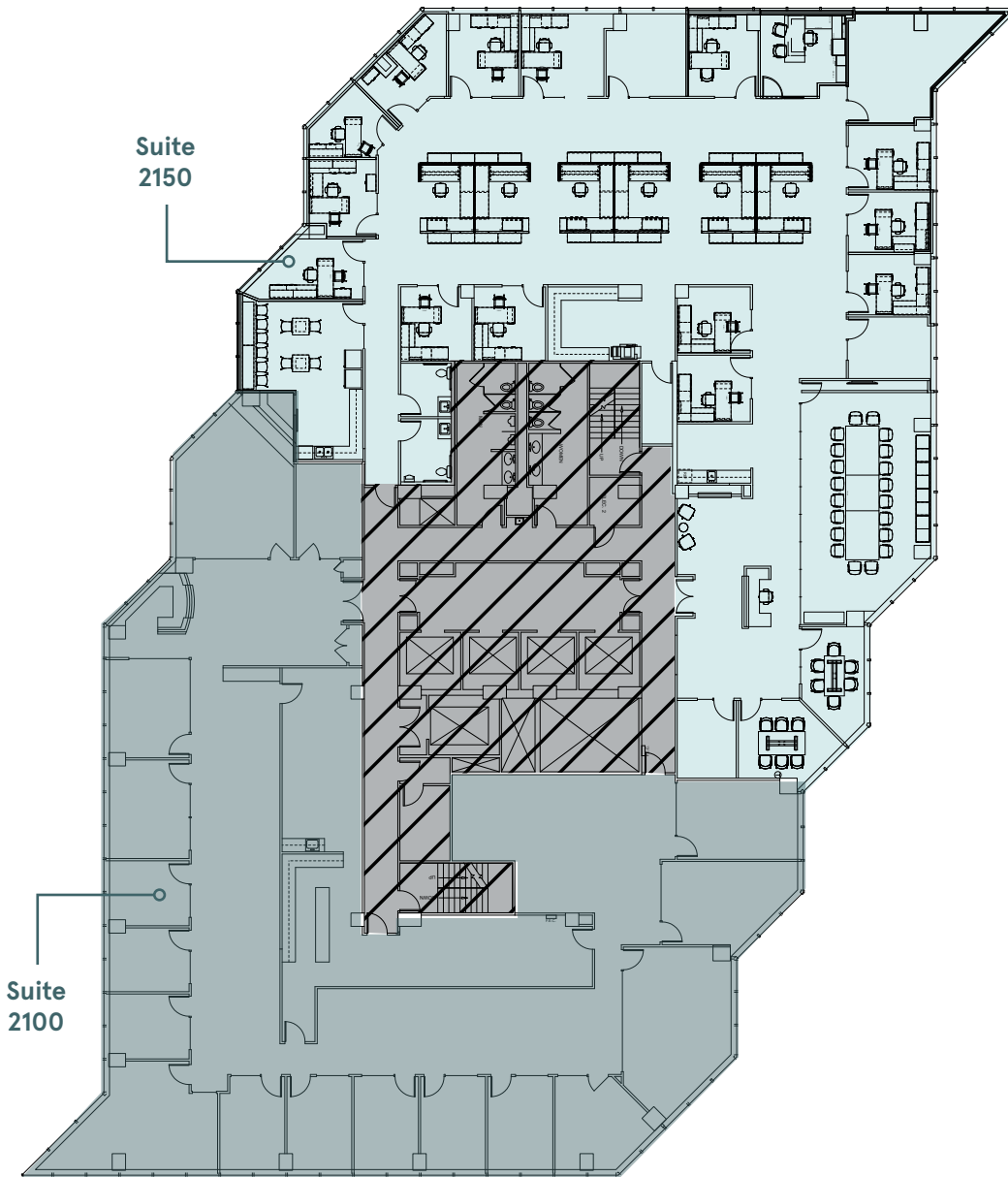

**SRO**® STERLING REALTY  
ORGANIZATION

**BRODERICK**  
• GROUP •

**GRANT YERKE**

425.646.5264

[yerke@broderickgroup.com](mailto:yerke@broderickgroup.com)

**MATT SCHRECK**

425.646.5232

[schreck@broderickgroup.com](mailto:schreck@broderickgroup.com)

The information contained herein has been given to us by the owner or sources that we deem reliable. We have no reason to doubt its accuracy, but we do not guarantee it. Prospective tenants should carefully verify all information contained herein.

↑  
**BACK TO  
AVAILABILITIES**