

# KENYON CENTER

3326 160TH AVE SE  
BELLEVUE, WA

**BRODERICK**  
· GROUP ·

For more information or to  
schedule a tour, please contact:

**PAUL JERUE**

425.646.5223

[jerue@broderickgroup.com](mailto:jerue@broderickgroup.com)

**ERIC HAEHL**

425.646.5266

[haehl@broderickgroup.com](mailto:haehl@broderickgroup.com)

## 2ND FLOOR

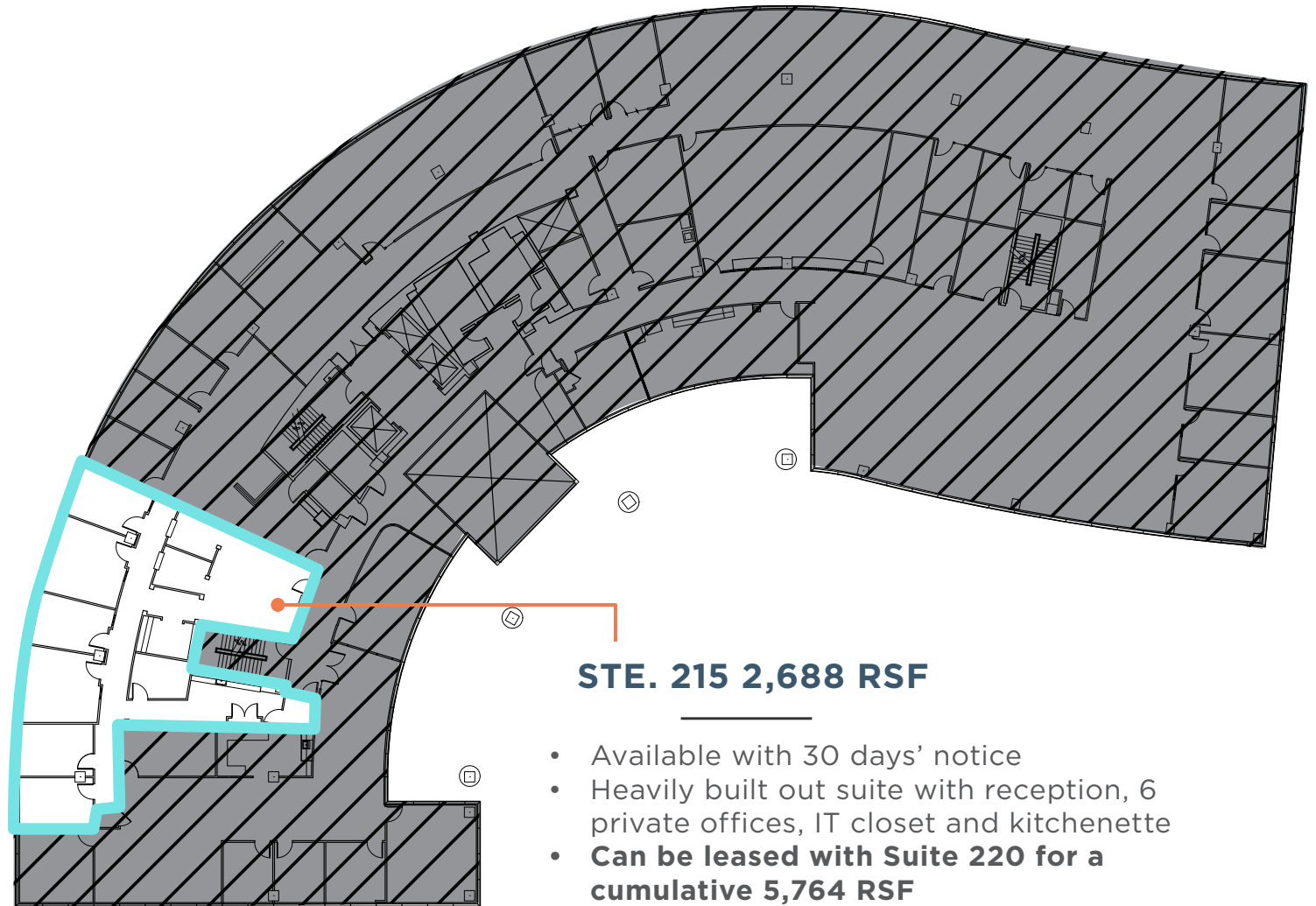

### STE. 215 2,688 RSF

- Available with 30 days' notice
- Heavily built out suite with reception, 6 private offices, IT closet and kitchenette
- **Can be leased with Suite 220 for a cumulative 5,764 RSF**

**BACK TO AVAILABLE SPACES**